



Installation guideline



Prerequisites

The concrete surface that will be the installation site and the alley in front of the stall bed surface must be clean. That concrete should be at least 3500 psi small aggregate for those curbs and stall beds.

Also, when installing in a new barn, the concrete should cure at least 30 days before drilling and pinning anything. Otherwise, the pins just push through the sidewalls of the drilled holes and don't compress which reduces their anchoring ability.



What you'll need to install the Animatress I

- Roll of rubber Top Cover 164' (50 m)
- PU Foam
- Protective plastic film roll
- Matstrip (white)
- Bevelled plastic strip BEV212 (gray)
- Split drive 212 and 112

Optional:

- Round plastic strip (to make a top cover joint)

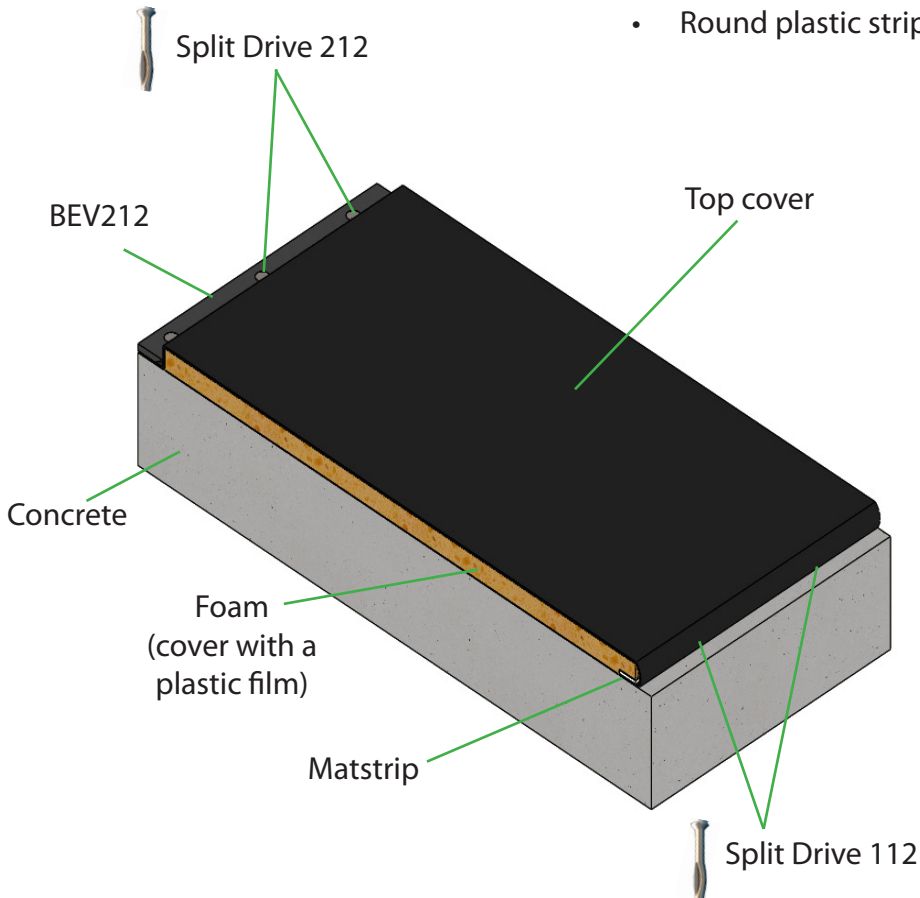

Additional tools needed (not supplied)

- 2 Hammer Drills
- 1/4" (6mm) Drill Bits 4" (10 cm) long
- Chalk box
- Cutters
- Digging Iron (post hole tamper)
- Utility knife (x-acto)
- Hammers
- 5 - 6 Ratchet Straps
- 5 - 6 Deep-jawed Vice Grips
- 25' - 30' tapes
- Extension cords

1

Strike a line on the top of the alley curb that is approximately 3" (7,62cm) in from the curb face at the closest point of the run. Use a long line since most curbs are NOT straight. When the installation is complete, the mattress should be about 1" (2,54cm) away from the curb face.

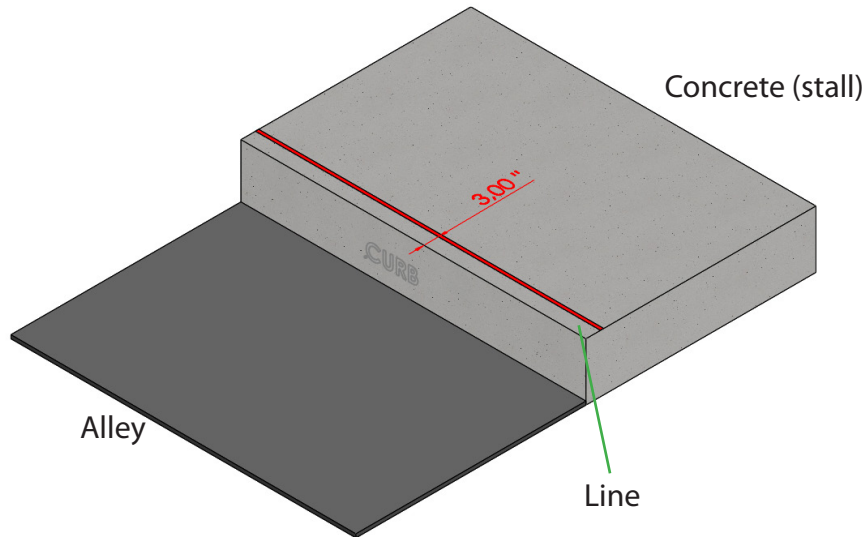

2

Lay out the top cover in the clean alley (orange side up) and position the edge that has the backing closest to the edge of the cover so that it touches the struck line. Check before unrolling the cover to make sure you have the correct side of the roll next to the curb. THEY ARE DIFFERENT.

Leave about 6"-12" (15,24cm - 30,48cm) of top cover at each short end of a run to allow for stretching when installing the plastic strip (BEV212).

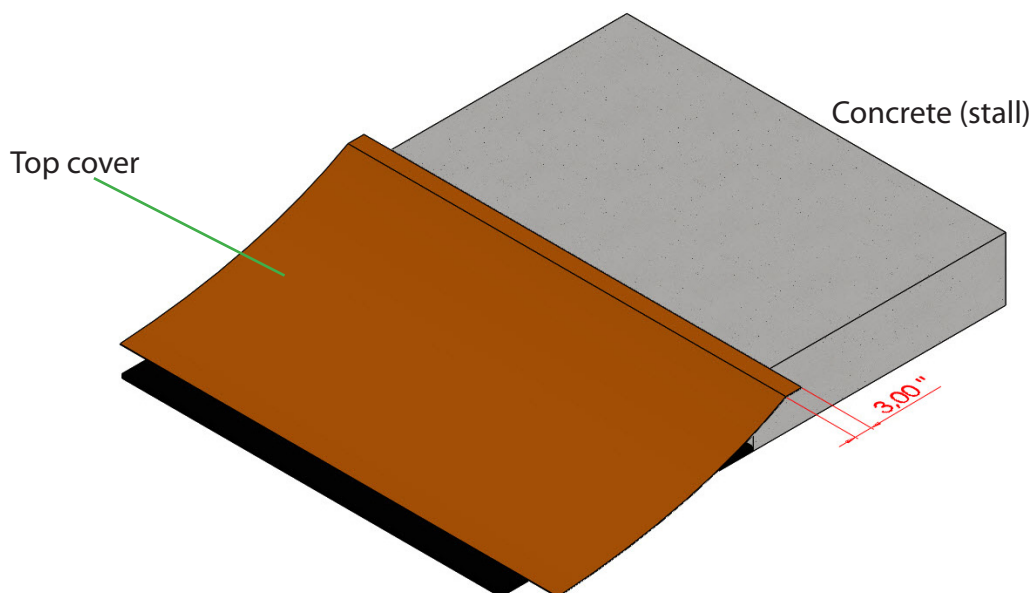

3

Install the plastic strip (Matstrip) flush with the edge of the cover, starting at one end of the cover with the first anchor being placed about 8" (20,32cm) away from the end of the run. Then install two more anchors about 6" (15,24cm) and 12" (30,48cm) from the first anchor after pulling all the slack out of the unrolled cover.

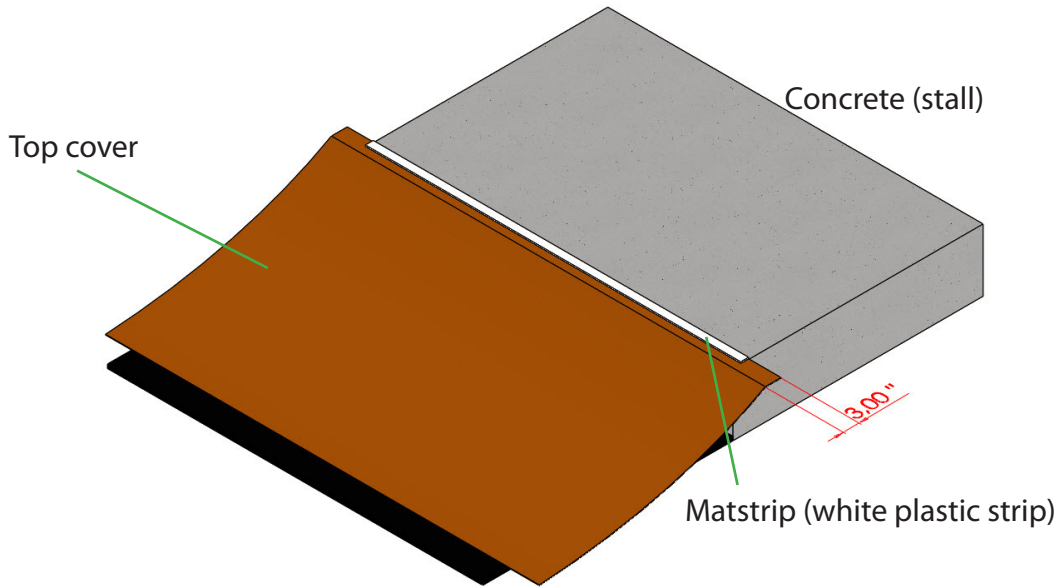

4

Go to the far end of the unrolled cover and pull it tight along the top of the curb. Drill and install a split drive (112) anchor every 8" - 12" (20,32cm - 30,48cm) in the plastic strips (Matstrip) as you move on down the length of the unrolled cover.

Make sure you drill the holes for the anchors with a 1/4" (0,64cm) hammer drill bit at least 3 1/2" (8,89cm) deep from the top of the plastic strip at the curb.



5

After the top cover has been positioned and installed on top of the curb, roll out the plastic film in the stall and on the top cover over the alley.

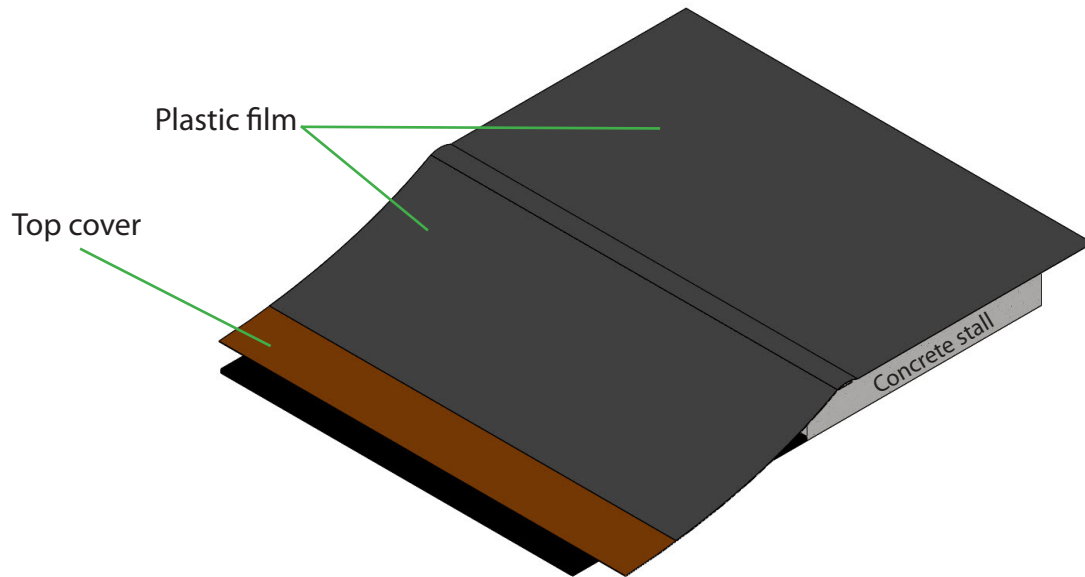

6

Lay out the foam pads over the plastic film, place the pads tightly against each other as you work down the stall platform. You might need to trim a foam pad at the ends of a row in order to leave a gap of about 5" (12,70cm) to allow for anchoring.

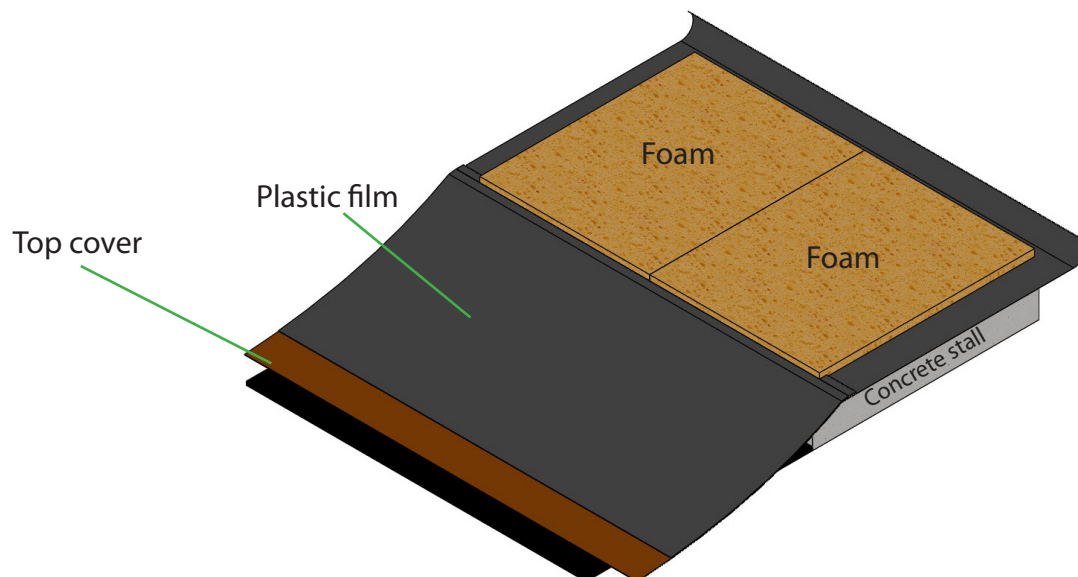

7

Wrap up the pads with the plastic film, every side need to be closed. Place the foam pads so that the tapered “notched” end is resting on top of the plastic strip (Matstrip) and the notch is “butted” snugly against the strip, or slightly past the strip towards the curb face.

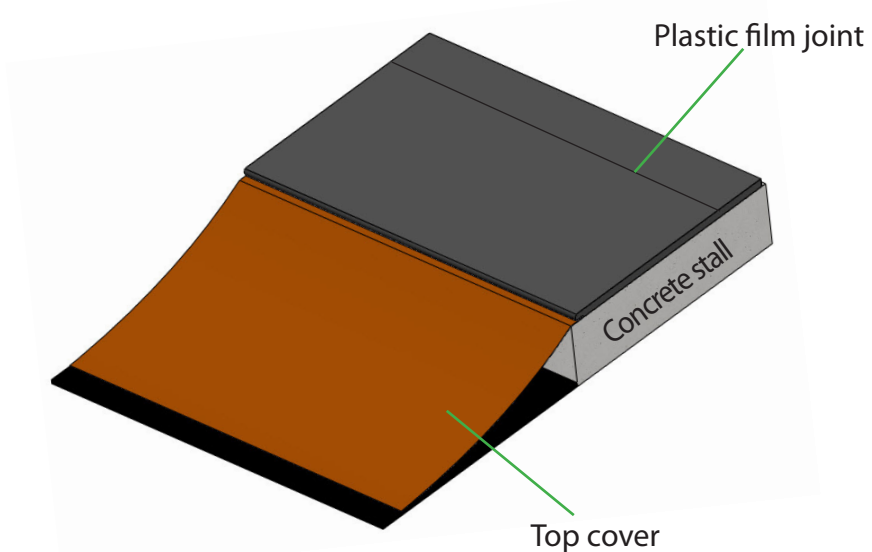

8

The top cover is folded back up over the foam pad towards the “head end” of the stall and pulled very tight to eliminate wrinkles, starting in the middle of the run. You may need to put a spacer in front of each foam when pulling the cover tight to keep the foam from being displaced from the correct “notch” location on top of the plastic strip. A simple way to do so is to use a piece of Mastrip (6”, 15 cm), nail it down in the center and curve both side up (picture 2).

Back view after tightening

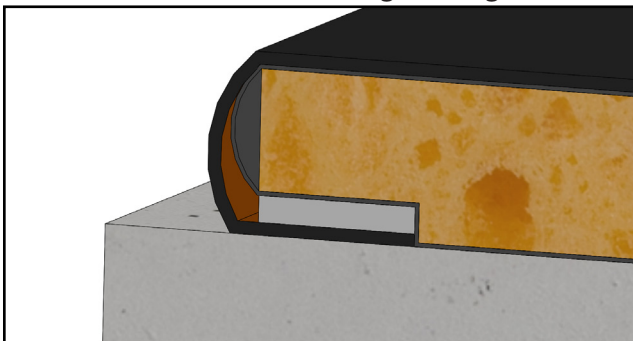

Spacer example

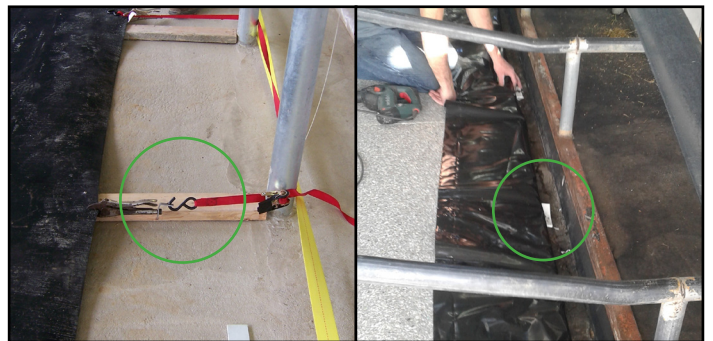

Picture 1

Picture 2

9

The top cover and the plastic film are anchored with the plastic strip (BEV212) and the split-drive anchors(212), spaced at 8" – 12" (20,32cm - 30,48cm) intervals along the length of the run and at both ends as well. Work your way first one way and then the other from center until the entire section is anchored and there are no wrinkles.

If you don't get the cover pulled tight before anchoring to the curb, or don't get the center of the run tight, you WILL have wrinkles.

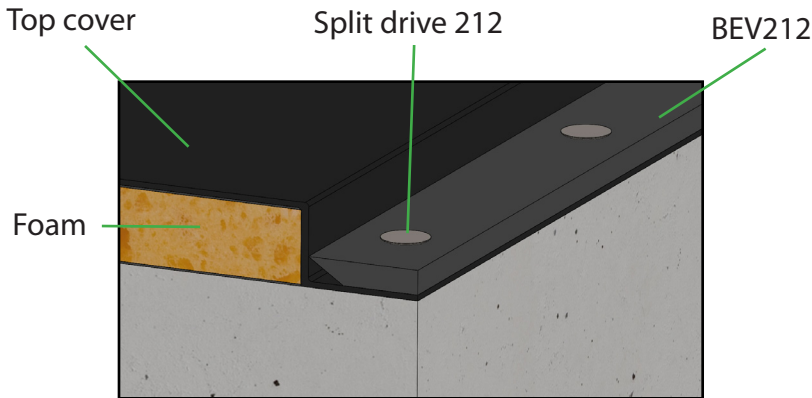

How to make a top cover joint

Step 1 : Overlap the two top cover by about 4-5" (10,16cm - 12,70cm) with the matstrip close to the curb, fix the matstrip with the split drive(212). Make sure to make the overlap under the free stall loop.

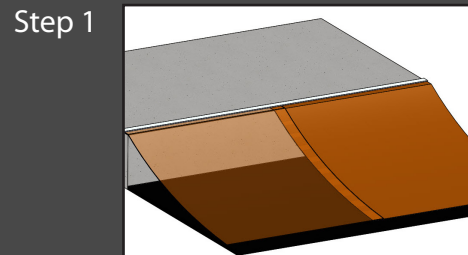
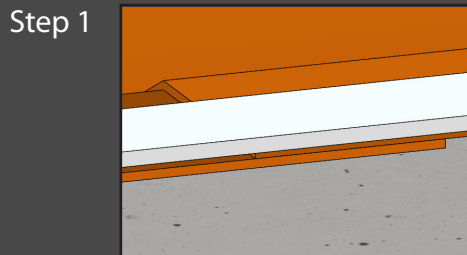

Step 2: When rolling the top cover over the foam, make sure to have a small gap of 3" (7,62cm) between the two foams where the overlap was done. Install a round plastic strip in that gap and use split drives(212) for anchoring.

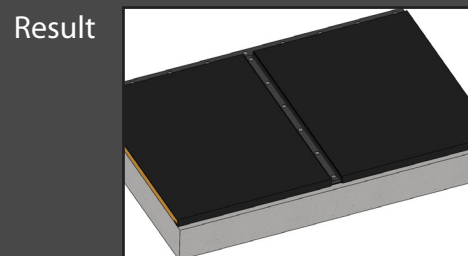
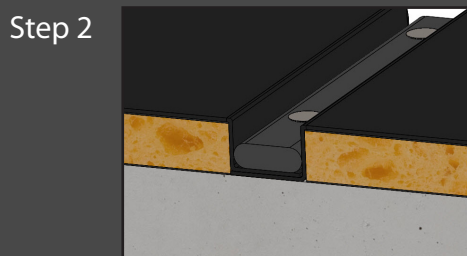

animat.ca

Animat
819-821-2091
395 rodolphe-Racine
Sherbrooke Qc,
Canada

